



# GRANDE COUNTRY



# Grande Country

- 2 🏠
- 3 🛋️
- 4 🛏️
- 2 🚗

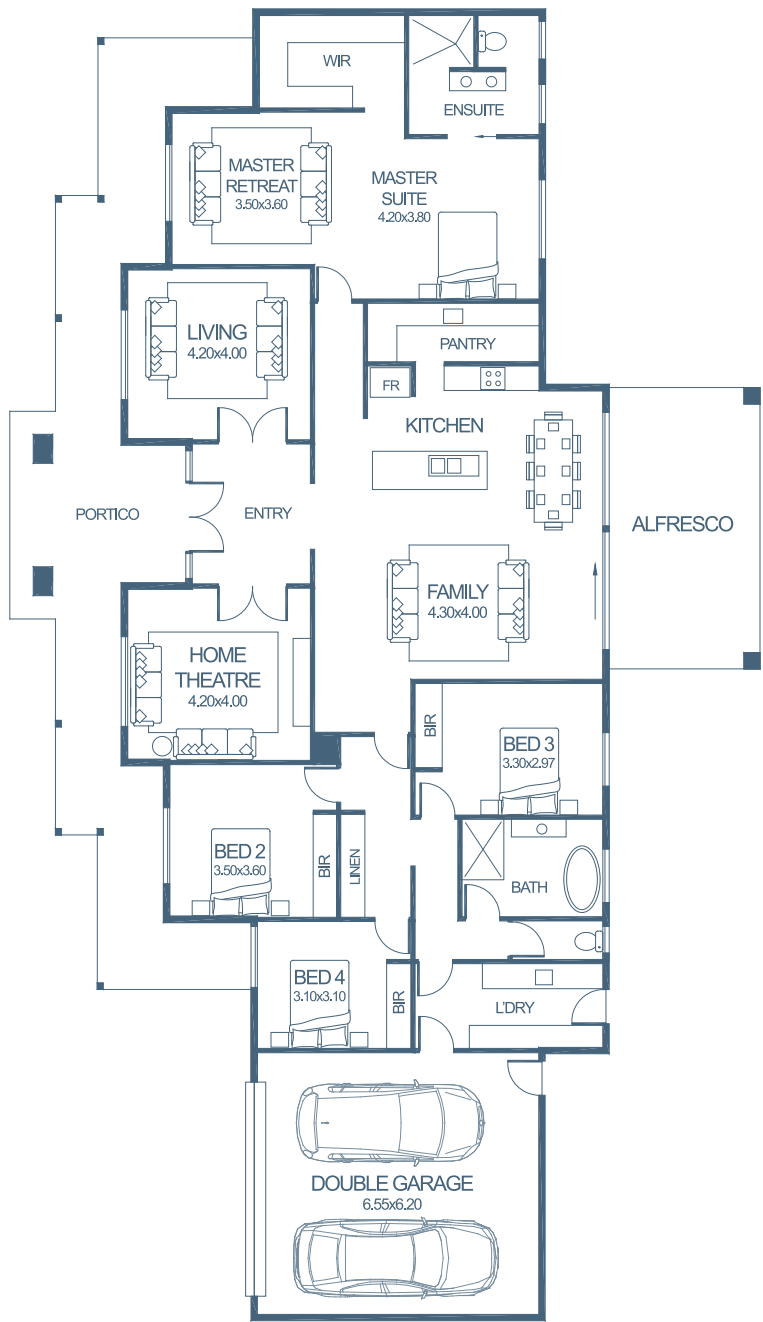

FLOORPLAN

The Grande Country home has a style of its own, with large open entry leading into the spacious open living and family areas



- FEATURES**
- Master Suite with Retreat, Walk in Robe & Ensuite
  - Separate Living Room
  - Home Theatre
  - Alfresco Area
  - 2550mm Ceilings
  - Large Walk in Pantry
  - 4 Bedrooms
  - Large Open Entry
  - Verandah
- HOME DIMENSIONS**
- Living Area 245.3m<sup>2</sup>
  - Garage Area 45.6m<sup>2</sup>
  - Alfresco Area 22.9m<sup>2</sup>
  - Portico 12.5m<sup>2</sup>
  - Verandah 37.5m<sup>2</sup>
  - Total Area 363.8m<sup>2</sup> (39.16sq)**
  - House Width 1716m
  - House Length 31.06m
  - Min. Block Width** Large Blocks
  - Min. Block Length** Rural Blocks
- UPGRADES**
- Study Option

Images are for illustrative purposes only & are subject to change dependant on land details; size, slope, scope etc.  
License NSW: 118052C VIC: DB-U4622 & CB-U4930